

# XL037 | Timing Belt Pulleys

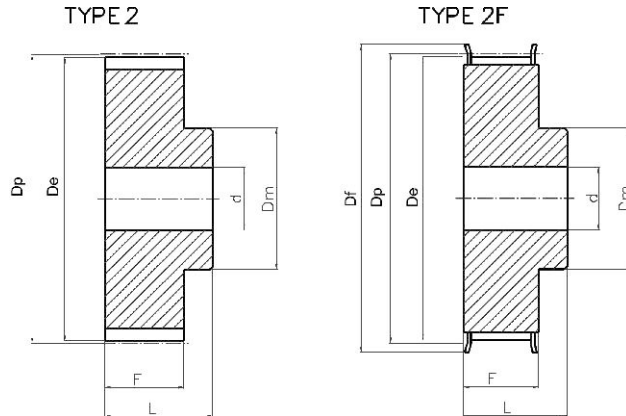

ISO5294-1989



## XL 037 PITCH 1/5" (5,08mm)

MATERIAL	CODE	TYPE	TEETH	Dp	De	Df	Dm	F	L	d	TYPE OF FLANGE	Kg.
ALUMINIUM	10XL 037	2F	10	16,17	15,66	23	10	14,3	20	-	201	0,01
	11XL 037	2F	11	17,79	17,28	23	10	14,3	20	-	201	0,01
	12XL 037	2F	12	19,40	18,90	25	10	14,3	20	-	203	0,01
	13XL 037	2F	13	21,02	20,51	25	10	14,3	20	-	203	0,01
	14XL 037	2F	14	22,64	23,13	28	16	14,3	20	-	204	0,02
	15XL 037	2F	15	24,25	23,75	28	16	14,3	20	-	204	0,02
	16XL 037	2F	16	25,87	25,36	32	16	14,3	20	-	205	0,03
	17XL 037	2F	17	27,49	26,98	32	20	14,3	20	-	205	0,03
	18XL 037	2F	18	29,11	28,60	36	20	14,3	20	-	206	0,04
	19XL 037	2F	19	30,72	30,21	36	20	14,3	22	-	206	0,04
	20XL 037	2F	20	32,34	31,83	38	25	14,3	22	-	207	0,05
	21XL 037	2F	21	33,96	33,45	38	25	14,3	22	-	207	0,05
	22XL 037	2F	22	35,57	35,07	42	25	14,3	22	-	208	0,06
	24XL 037	2F	24	38,81	38,30	44	30	14,3	22	-	209	0,06
	26XL 037	2F	26	42,04	41,53	48	30	14,3	22	8	210	0,09
	27XL 037	2F	27	43,66	43,15	48	34	14,3	22	8	210	0,09
	28XL 037	2F	28	45,28	44,77	51	34	14,3	22	8	211	0,10
	30XL 037	2F	30	48,51	48,00	54	38	14,3	22	8	212	0,12
	32XL 037	2F	32	51,74	51,24	57	38	14,3	25	8	213	0,12
	34XL 037	2F	34	54,98	54,47	60	38	14,3	25	8	214	0,13
	35XL 037	2F	35	56,60	56,09	63	38	14,3	25	8	215	0,14
	36XL 037	2	36	58,21	57,70	-	45	14,3	25	8	-	0,14
	38XL 037	2	38	61,45	60,94	-	45	14,3	25	8	-	0,15
	40XL 037	2	40	64,48	64,17	-	45	14,3	25	8	-	0,16
	42XL 037	2	42	67,91	67,41	-	45	14,3	25	8	-	0,18
	44XL 037	2	44	71,15	70,64	-	45	14,3	25	8	-	0,19
	48XL 037	2	48	77,62	77,11	-	45	14,3	25	10	-	0,19
	52XL 037	2	52	84,08	83,57	-	45	14,3	25	10	-	0,19
	60XL 037	2	60	97,02	96,51	-	45	14,3	25	10	-	0,22
	72XL 037	2	72	116,42	115,92	-	45	14,3	25	10	-	0,44

# L050 | Timing Belt Pulleys



ISO5294-1989



Accept OEM purchase.

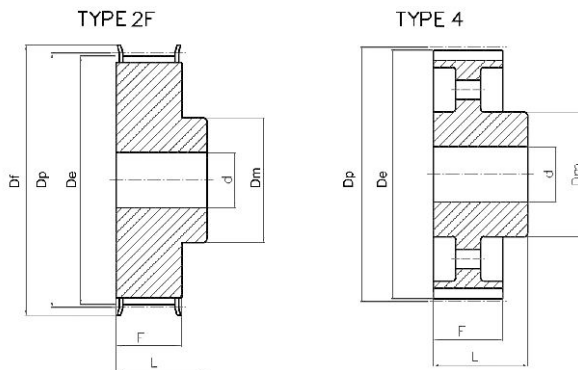

## L 050 PITCH 3/8" (9,525mm)

MATERIAL	CODE	TYPE	TEETH	Dp	De	Df	Dm	F	L	d	TYPE OF FLANGE	Kg.
STEEL	10L 050	2F	10	30,32	29,56	36	20	19,0	28	8	300	0,11
	11L 050	2F	11	33,35	32,59	38	24	19,0	30	8	301	0,14
	12L 050	2F	12	36,38	35,62	42	24	19,0	30	8	302	0,17
	13L 050	2F	13	39,41	38,65	44	28	19,0	30	8	303	0,21
	14L 050	2F	14	42,44	41,68	48	28	19,0	30	8	304	0,24
	15L 050	2F	15	45,48	44,72	51	34	19,0	30	8	305	0,29
	16L 050	2F	16	48,51	47,75	54	36	19,0	32	8	306	0,33
	17L 050	2F	17	51,54	50,78	57	36	19,0	32	10	307	0,38
	18L 050	2F	18	54,57	53,81	60	40	19,0	32	10	308	0,44
	19L 050	2F	19	57,61	56,84	63	40	19,0	32	10	309	0,47
	20L 050	2F	20	60,64	59,88	66	40	19,0	32	10	310	0,51
	21L 050	2F	21	63,67	62,91	71	45	19,0	32	10	311	0,60
	22L 050	2F	22	66,70	65,94	75	45	19,0	32	10	312	0,64
	23L 050	2F	23	69,73	68,97	79	55	19,0	32	10	313	0,78
	24L 050	2F	24	72,77	72,00	79	55	19,0	32	10	313	0,81
	25L 050	2F	25	75,80	75,04	83	58	19,0	32	10	314	0,89
	26L 050	2F	26	78,83	78,07	87	58	19,0	32	12	315	0,94
	27L 050	2F	27	81,86	81,10	87	58	19,0	32	12	315	0,99
	28L 050	2F	28	84,89	84,13	91	58	19,0	32	12	316	1,04
	30L 050	2F	30	90,96	90,20	97	70	19,0	32	12	318	1,17
	32L 050	2F	32	97,03	96,26	103	70	19,0	32	12	320	1,41
	33L 050	2F	33	100,05	99,29	106	70	19,0	32	12	321	1,49
	34L 050	2F	34	103,08	102,32	111	70	19,0	32	12	322	1,57
	35L 050	2F	35	106,12	105,35	111	70	19,0	32	12	322	1,62
	36L 050	2F	36	109,15	108,39	115	70	19,0	32	12	323	1,70
	40L 050	2F	40	121,29	120,51	127	70	19,0	32	12	327	2,03
	42L 050	2F	42	127,34	126,58	135	70	19,0	32	12	328	2,21
	44L 050	2F	44	133,40	132,64	140	70	19,0	32	12	330	2,38
	45L 050	2F	45	136,44	135,67	143	70	19,0	32	12	331	2,48
	48L 050	2F	48	145,53	144,77	152	70	19,0	32	12	334	2,78
CAST IRON	50L 050	4	50	151,60	150,83	-	70	19,0	32	14	-	1,74
	52L 050	4	52	157,66	156,90	-	70	19,0	32	14	-	1,80
	56L 050	4	56	169,79	169,02	-	70	19,0	32	14	-	1,87
	57L 050	4	57	172,82	172,06	-	70	19,0	32	14	-	1,88
	60L 050	4	60	181,91	181,15	-	75	19,0	42	14	-	2,41
	72L 050	4	72	218,29	217,53	-	75	19,0	42	14	-	2,82
	84L 050	4	84	254,68	253,92	-	75	19,0	42	14	-	3,08
	96L 050	4	96	291,06	290,30	-	75	19,0	42	14	-	3,42

Timing Belt Pulleys

# L075 | Timing Belt Pulleys



ISO5294-1989

Accept OEM purchase.

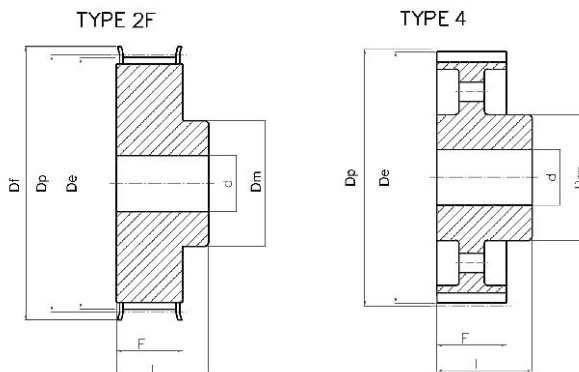

## L 075 PITCH 3/8" (9,525mm)

MATERIAL	CODE	TYPE	TEETH	Dp	De	Df	Dm	F	L	d	TYPE OF FLANGE	Kg.
STEEL	10L 075	2F	10	30,32	29,56	36	20	25,4	38	8	300	0,14
	11L 075	2F	11	33,35	32,59	38	24	25,4	38	8	301	0,18
	12L 075	2F	12	36,38	35,62	42	24	25,4	38	8	302	0,22
	13L 075	2F	13	39,41	38,65	44	28	25,4	38	8	303	0,26
	14L 075	2F	14	42,44	41,68	48	28	25,4	38	8	304	0,30
	15L 075	2F	15	45,48	44,72	51	34	25,4	38	8	305	0,37
	16L 075	2F	16	48,51	47,75	54	36	25,4	38	8	306	0,43
	17L 075	2F	17	51,54	50,78	57	36	25,4	38	10	307	0,46
	18L 075	2F	18	54,57	53,81	60	40	25,4	38	10	308	0,54
	19L 075	2F	19	57,61	56,84	63	40	25,4	38	10	309	0,58
	20L 075	2F	20	60,64	59,88	66	40	25,4	38	10	310	0,64
	21L 075	2F	21	63,67	62,91	71	45	25,4	38	10	311	0,71
	22L 075	2F	22	66,70	65,94	75	45	25,4	38	10	312	0,79
	23L 075	2F	23	69,73	68,97	79	55	25,4	38	10	313	0,94
	24L 075	2F	24	72,77	72,00	79	55	25,4	38	10	313	1,00
	25L 075	2F	25	75,80	75,04	83	58	25,4	38	10	314	1,10
	26L 075	2F	26	78,83	78,07	87	58	25,4	38	12	315	1,16
	27L 075	2F	27	81,86	81,10	87	58	25,4	38	12	315	1,22
	28L 075	2F	28	84,89	84,13	91	58	25,4	38	12	316	1,30
	30L 075	2F	30	90,96	90,20	97	70	25,4	38	12	318	1,47
	32L 075	2F	32	97,03	96,26	103	70	25,4	38	12	320	1,75
	33L 075	2F	33	100,05	99,29	106	70	25,4	38	12	321	1,85
	34L 075	2F	34	103,08	102,32	111	70	25,4	38	12	322	1,93
	35L 075	2F	35	106,12	105,35	111	70	25,4	38	12	322	2,03
36L 075	2F	36	109,15	108,39	115	70	25,4	38	12	323	2,14	
40L 075	2F	40	121,29	120,51	127	70	25,4	38	12	327	2,56	
42L 075	2F	42	127,34	126,58	135	70	25,4	38	12	328	2,81	
44L 075	2F	44	133,40	132,64	140	70	25,4	38	12	330	3,02	
45L 075	2F	45	136,44	135,67	143	70	25,4	38	12	331	3,16	
48L 075	2F	48	145,53	144,77	152	70	25,4	38	12	334	3,57	
CAST IRON	50L 075	4	50	151,60	150,83	-	70	25,4	38	14	-	2,10
	52L 075	4	52	157,66	156,90	-	70	25,4	38	14	-	2,13
	56L 075	4	56	169,79	169,02	-	70	25,4	38	14	-	2,27
	57L 075	4	57	172,82	172,06	-	70	25,4	38	14	-	2,28
	60L 075	4	60	181,91	181,15	-	75	25,4	45	14	-	2,70
	72L 075	4	72	218,29	217,53	-	75	25,4	45	14	-	3,19
	84L 075	4	84	254,68	253,92	-	75	25,4	45	14	-	3,64
	96L 075	4	96	291,06	290,30	-	75	25,4	45	14	-	4,04

# L100 | Timing Belt Pulleys



ISO5294-1989

Accept OEM purchase.

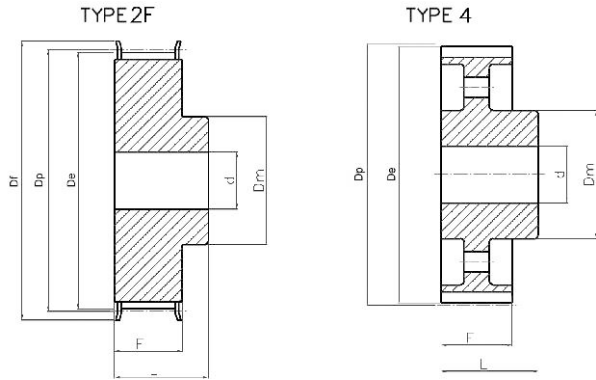

L 100 PITCH 3/8" (9,525mm)

MATERIAL	CODE	TYPE	TEETH	Dp	De	Df	Dm	F	L	d	TYPE OF FLANGE	Kg.	
STEEL	10L 100	2F	10	30,32	29,56	36	20	31,8	45	8	300	0,17	
	11L 100	2F	11	33,35	32,59	38	24	31,8	45	8	301	0,22	
	12L 100	2F	12	36,38	35,62	42	24	31,8	45	8	302	0,26	
	13L 100	2F	13	39,41	38,65	44	28	31,8	45	8	303	0,32	
	14L 100	2F	14	42,44	41,68	48	28	31,8	45	10	304	0,35	
	15L 100	2F	15	45,48	44,72	51	34	31,8	45	10	305	0,43	
	16L 100	2F	16	48,51	47,75	54	36	31,8	45	10	306	0,50	
	17L 100	2F	17	51,54	50,78	57	36	31,8	45	10	307	0,56	
	18L 100	2F	18	54,57	53,81	60	40	31,8	45	10	308	0,64	
	19L 100	2F	19	57,61	56,84	63	40	31,8	45	10	309	0,70	
	20L 100	2F	20	60,64	59,88	66	40	31,8	45	10	310	0,77	
	21L 100	2F	21	63,67	62,91	71	45	31,8	45	10	311	0,88	
	22L 100	2F	22	66,70	65,94	75	45	31,8	45	12	312	0,95	
	23L 100	2F	23	69,73	68,97	79	55	31,8	45	12	313	1,11	
	24L 100	2F	24	72,77	72,00	79	55	31,8	45	12	313	1,18	
	25L 100	2F	25	75,80	75,04	83	58	31,8	45	12	314	1,30	
	26L 100	2F	26	78,83	78,07	87	58	31,8	45	12	315	1,40	
	27L 100	2F	27	81,86	81,10	87	58	31,8	45	12	315	1,47	
	28L 100	2F	28	84,89	84,13	91	58	31,8	45	12	316	1,58	
	30L 100	2F	30	90,96	90,20	97	70	31,8	45	12	318	1,78	
	32L 100	2F	32	97,03	96,26	103	70	31,8	45	12	320	2,11	
	33L 100	2F	33	100,05	99,29	106	70	31,8	45	12	321	2,23	
	34L 100	2F	34	103,08	102,32	111	70	31,8	45	12	322	2,39	
	35L 100	2F	35	106,12	105,35	111	70	31,8	45	12	322	2,45	
	36L 100	2F	36	109,15	108,39	115	70	31,8	45	12	323	2,59	
	40L 100	2F	40	121,29	120,51	127	70	31,8	45	12	327	3,13	
	42L 100	2F	42	127,34	126,58	135	70	31,8	45	12	328	3,43	
	44L 100	2F	44	133,40	132,64	140	70	31,8	45	12	330	3,72	
	45L 100	2F	45	136,44	135,67	143	70	31,8	45	12	331	3,89	
	48L 100	2F	48	145,53	144,77	152	70	31,8	45	12	334	4,38	
	CAST IRON	50L 100	4	50	151,60	150,83	-	70	31,8	45	14	-	2,41
		52L 100	4	52	157,66	156,90	-	70	31,8	45	14	-	2,55
		56L 100	4	56	169,79	169,02	-	70	31,8	45	14	-	2,65
		57L 100	4	57	172,82	172,06	-	70	31,8	45	14	-	2,71
		60L 100	4	60	181,91	181,15	-	75	31,8	45	14	-	3,11
		72L 100	4	72	218,29	217,53	-	75	31,8	45	14	-	3,65
84L 100		4	84	254,68	253,92	-	75	31,8	45	14	-	4,12	
96L 100		4	96	291,06	290,30	-	75	31,8	45	14	-	4,60	

# H075 | Timing Belt Pulleys



ISO5294-1989

Accept OEM purchase.

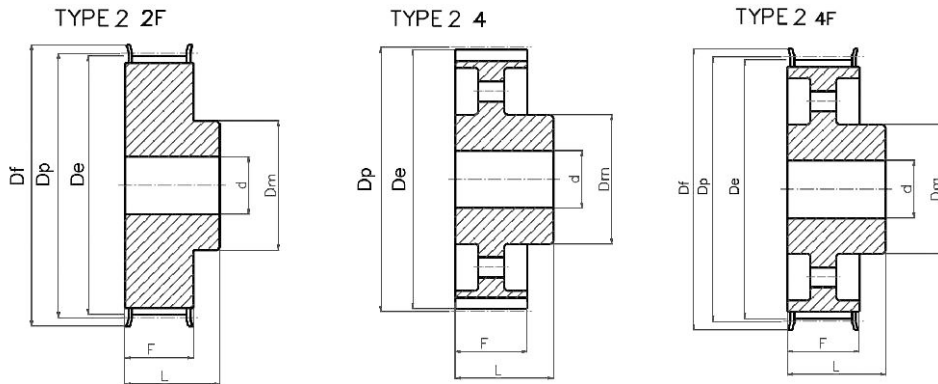

## H075 PITCH 1/2" (12,7mm)

MATERIAL	CODE	TYPE	TEETH	Dp	De	Df	Dm	F	L	d	TYPE OF FLANGE	Kg.
STEEL	14H 075	2F	14	56,59	55,22	63	40	26,4	40	10	309	0,58
	15H 075	2F	15	60,64	59,27	66	45	26,4	40	10	310	0,69
	16H 075	2F	16	64,68	63,31	71	45	26,4	40	10	311	0,77
	17H 075	2F	17	68,72	67,35	75	45	26,4	40	12	312	0,84
	18H 075	2F	18	72,77	71,39	79	55	26,4	40	12	313	1,01
	19H 075	2F	19	76,81	75,44	83	60	26,4	40	12	314	1,15
	20H 075	2F	20	80,85	79,48	87	62	26,4	40	12	315	1,27
	21H 075	2F	21	84,89	83,52	91	65	26,4	40	12	316	1,41
	22H 075	2F	22	88,94	87,56	93	68	26,4	40	12	317	1,55
	23H 075	2F	23	92,98	91,61	97	72	26,4	40	12	318	1,71
	24H 075	2F	24	97,03	95,65	103	72	26,4	40	12	320	1,83
	25H 075	2F	25	101,06	99,69	106	72	26,4	40	12	321	1,96
	26H 075	2F	26	105,11	103,73	111	80	26,4	40	12	322	2,19
	27H 075	2F	27	109,15	107,78	115	80	26,4	40	12	323	2,32
	28H 075	2F	28	113,19	111,82	119	80	26,4	40	12	325	2,47
	30H 075	2F	30	121,29	119,90	127	80	26,4	40	14	327	2,76
	32H 075	2F	32	129,36	127,99	135	80	26,4	40	14	328	3,08
	33H 075	2F	33	133,40	132,03	140	80	26,4	40	14	330	3,25
	34H 075	2F	34	137,45	136,07	143	80	26,4	40	14	331	3,42
	35H 075	2F	35	141,49	140,12	148	80	26,4	40	14	333	3,61
36H 075	2F	36	145,53	144,16	152	80	26,4	40	14	334	3,79	
38H 075	2F	38	153,62	152,24	158	80	26,4	40	14	335	4,16	
40H 075	2F	40	161,70	160,33	168	80	26,4	40	14	338	4,58	
CAST IRON	44H 075	4F	44	177,87	176,50	184	80	26,4	40	18	339	2,57
	48H 075	4F	48	194,04	192,67	200	90	26,4	45	18	342	3,56
	50H 075	4	50	202,13	200,75	-	90	26,4	45	18	-	3,74

# H100

## Timing Belt Pulleys



ISO5294-1989

Accept OEM purchase.

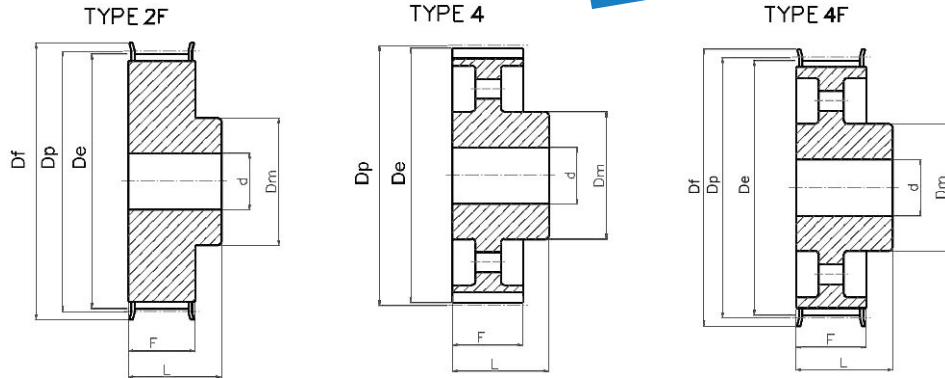

### H100 PITCH 1/2" (12,7mm)

MATERIAL	CODE	TYPE	TEETH	Dp	De	Df	Dm	F	L	d	TYPE OF FLANGE	Kg.
STEEL	14H 100	2F	14	56,59	55,22	63	40	31,8	45	12	309	0,65
	15H 100	2F	15	60,64	59,27	66	45	31,8	45	12	310	0,77
	16H 100	2F	16	64,68	63,31	71	45	31,8	45	12	311	0,87
	17H 100	2F	17	68,72	67,35	75	45	31,8	45	12	312	0,97
	18H 100	2F	18	72,77	71,39	79	55	31,8	45	12	313	1,16
	19H 100	2F	19	76,81	75,44	83	60	31,8	45	14	314	1,30
	20H 100	2F	20	80,85	79,48	87	62	31,8	45	14	315	1,44
	21H 100	2F	21	84,89	83,52	91	65	31,8	45	14	316	1,60
	22H 100	2F	22	88,94	87,56	93	68	31,8	45	14	317	1,76
	23H 100	2F	23	92,98	91,61	97	72	31,8	45	14	318	1,94
	24H 100	2F	24	97,03	95,65	103	72	31,8	45	14	320	2,09
	25H 100	2F	25	101,06	99,69	106	72	31,8	45	14	321	2,24
	26H 100	2F	26	105,11	103,73	111	80	31,8	45	14	322	2,49
	27H 100	2F	27	109,15	107,78	115	80	31,8	45	14	323	2,66
	28H 100	2F	28	113,19	111,82	119	80	31,8	45	14	325	2,83
	29H 100	2F	29	117,23	115,86	123	80	31,8	45	14	326	3,01
	30H 100	2F	30	121,29	119,90	127	80	31,8	45	14	327	3,19
	32H 100	2F	32	129,36	127,99	135	80	31,8	45	14	328	3,57
	33H 100	2F	33	133,40	132,03	140	80	31,8	45	14	330	3,79
	34H 100	2F	34	137,45	136,07	143	80	31,8	45	14	331	3,99
35H 100	2F	35	141,49	140,12	148	80	31,8	45	14	333	4,20	
36H 100	2F	36	145,53	144,16	152	80	31,8	45	14	334	4,44	
38H 100	2F	38	153,62	152,24	158	80	31,8	45	14	335	4,90	
40H 100	2F	40	161,70	160,33	168	80	31,8	45	14	338	5,39	
CAST IRON	44H 100	4F	44	177,87	176,50	184	80	31,8	50	18	339	3,37
	45H 100	4F	45	181,91	180,54	192	80	31,8	50	18	340	3,57
	48H 100	4F	48	194,04	192,67	200	90	31,8	50	18	342	4,10
	50H 100	4	50	202,13	200,75	-	90	31,8	50	18	-	4,24
	52H 100	4	52	210,21	208,84	-	90	31,8	50	18	-	4,32
	58H 100	4	58	234,47	233,09	-	90	31,8	50	18	-	4,61
	60H 100	4	60	242,55	241,18	-	100	31,8	50	18	-	5,30
	70H 100	4	70	282,98	281,61	-	100	31,8	55	18	-	6,13
	72H 100	4	72	291,06	289,69	-	120	31,8	55	18	-	7,47
	84H 100	4	84	339,57	338,20	-	120	31,8	55	18	-	8,52
	96H 100	4	96	388,08	386,71	-	120	31,8	60	18	-	10,25
	120H 100	4	120	485,10	483,73	-	120	31,8	60	18	-	13,09

### ISO5294-1989

Accept OEM purchase.

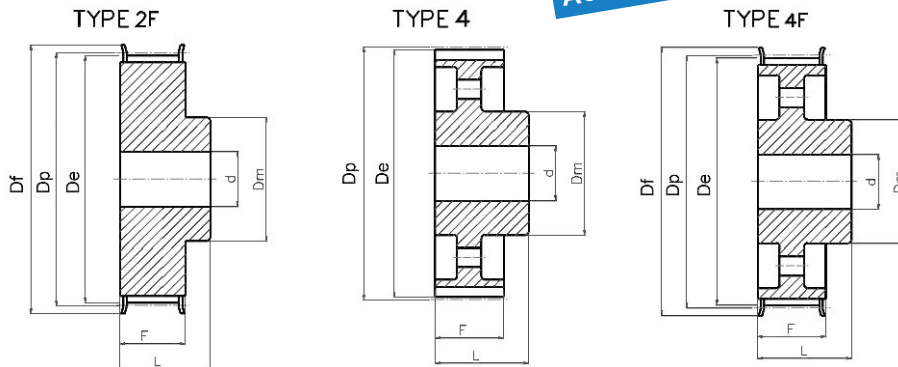

### H150 PITCH 1/2" (12,7mm)

MATERIAL	CODE	TYPE	TEETH	Dp	De	Df	Dm	F	L	d	TYPE OF FLANGE	Kg.
STEEL	14H 150	2F	14	56,59	55,22	63	40	46,0	58	18	309	0,81
	15H 150	2F	15	60,64	59,27	66	45	46,0	58	18	310	0,97
	16H 150	2F	16	64,68	63,31	71	45	46,0	58	18	311	1,11
	17H 150	2F	17	68,72	67,35	75	45	46,0	58	18	312	1,25
	18H 150	2F	18	72,77	71,39	79	55	46,0	58	18	313	1,48
	19H 150	2F	19	76,81	75,44	83	60	46,0	58	18	314	1,68
	20H 150	2F	20	80,85	79,48	87	62	46,0	58	18	315	1,88
	21H 150	2F	21	84,89	83,52	91	65	46,0	58	18	316	2,08
	22H 150	2F	22	88,94	87,56	93	68	46,0	58	18	317	2,30
	23H 150	2F	23	92,98	91,61	97	72	46,0	58	18	318	2,54
	24H 150	2F	24	97,03	95,65	103	72	46,0	58	18	320	2,75
	25H 150	2F	25	101,06	99,69	106	72	46,0	58	18	321	2,97
	26H 150	2F	26	105,11	103,73	111	80	46,0	58	18	322	3,29
	27H 150	2F	27	109,15	107,78	115	80	46,0	58	18	323	3,52
	28H 150	2F	28	113,19	111,82	119	80	46,0	58	18	325	3,78
	29H 150	2F	29	117,23	115,86	123	80	46,0	58	18	326	4,03
	30H 150	2F	30	121,29	119,90	127	80	46,0	58	18	327	4,29
	32H 150	2F	32	129,36	127,99	135	80	46,0	58	18	328	4,86
	33H 150	2F	33	133,40	132,03	140	80	46,0	58	18	330	5,15
	34H 150	2F	34	137,45	136,07	143	80	46,0	58	18	331	5,46
35H 150	2F	35	141,49	140,12	148	80	46,0	58	18	333	5,78	
36H 150	2F	36	145,53	144,16	152	80	46,0	58	18	334	6,09	
38H 150	2F	38	153,62	152,24	158	80	46,0	58	18	335	6,74	
40H 150	2F	40	161,70	160,33	168	80	46,0	58	18	338	7,46	
CAST IRON	44H 150	4F	44	177,87	176,50	184	80	46,0	58	18	339	4,29
	45H 150	4F	45	181,91	180,54	192	80	46,0	58	18	340	4,44
	48H 150	4F	48	194,04	192,67	200	90	46,0	65	18	342	5,41
	50H 150	4	50	202,13	200,75	-	90	46,0	65	18	-	5,59
	52H 150	4	52	210,21	208,84	-	90	46,0	65	18	-	5,79
	58H 150	4	58	234,47	233,09	-	90	46,0	65	18	-	6,15
	60H 150	4	60	242,55	241,18	-	100	46,0	65	18	-	7,08
	70H 150	4	70	282,98	281,61	-	100	46,0	65	24	-	7,77
	72H 150	4	72	291,06	289,69	-	120	46,0	65	24	-	9,70
	84H 150	4	84	339,57	338,20	-	120	46,0	65	24	-	10,99
	96H 150	4	96	388,08	386,71	-	120	46,0	65	24	-	12,24
	120H 150	4	120	485,10	483,73	-	120	46,0	65	24	-	16,17

# H200 | Timing Belt Pulleys



ISO5294-1989

Accept OEM purchase.

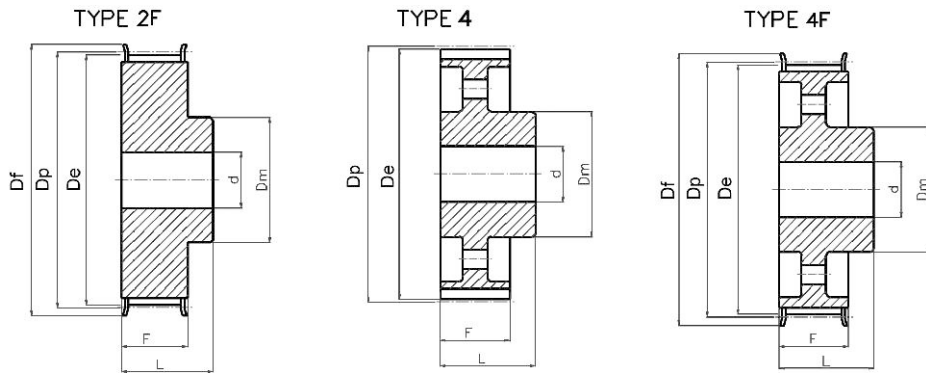

## H200 PITCH 1/2" (12,7mm)

MATERIAL	CODE	TYPE	TEETH	Dp	De	Df	Dm	F	L	d	TYPE OF FLANGE	Kg.
STEEL	14H 200	2F	14	56,59	55,22	63	40	58,7	70	18	309	1,10
	15H 200	2F	15	60,64	59,27	66	45	58,7	70	18	310	1,33
	16H 200	2F	16	64,68	63,31	71	45	58,7	70	18	311	1,54
	17H 200	2F	17	68,72	67,35	75	45	58,7	70	18	312	1,69
	18H 200	2F	18	72,77	71,39	79	50	58,7	70	18	313	1,95
	19H 200	2F	19	76,81	75,44	83	60	58,7	70	18	314	2,20
	20H 200	2F	20	80,85	79,48	87	62	58,7	70	18	315	2,44
	21H 200	2F	21	84,89	83,52	91	65	58,7	70	18	316	2,70
	22H 200	2F	22	88,94	87,56	93	68	58,7	70	18	317	2,97
	23H 200	2F	23	92,98	91,61	97	72	58,7	70	18	318	3,25
	24H 200	2F	24	97,03	95,65	103	72	58,7	70	18	320	3,56
	25H 200	2F	25	101,06	99,69	106	72	58,7	70	18	321	3,81
	26H 200	2F	26	105,11	103,73	111	80	58,7	70	18	322	4,18
	27H 200	2F	27	109,15	107,78	115	80	58,7	70	18	323	4,49
	28H 200	2F	28	113,19	111,82	119	80	58,7	70	18	325	4,81
	29H 200	2F	29	117,23	115,86	123	80	58,7	70	18	326	5,14
	30H 200	2F	30	121,29	119,90	127	80	58,7	70	18	327	5,47
	32H 200	2F	32	129,36	127,99	135	80	58,7	70	18	328	6,17
	33H 200	2F	33	133,40	132,03	140	80	58,7	70	18	330	6,56
	34H 200	2F	34	137,45	136,07	143	80	58,7	70	18	331	6,94
35H 200	2F	35	141,49	140,12	148	80	58,7	70	18	333	7,34	
36H 200	2F	36	145,53	144,16	152	80	58,7	70	18	334	7,75	
38H 200	2F	38	153,62	152,24	158	80	58,7	70	18	335	8,62	
40H 200	2F	40	161,70	160,33	168	80	58,7	70	18	338	9,50	
CAST IRON	44H 200	4F	44	177,87	176,50	184	80	58,7	70	18	339	5,14
	45H 200	4F	45	181,91	180,54	192	80	58,7	70	18	340	5,38
	48H 200	4F	48	194,04	192,67	200	90	58,7	75	24	342	6,29
	50H 200	4	50	202,13	200,75	-	90	58,7	75	24	-	6,68
	52H 200	4	52	210,21	208,84	-	90	58,7	75	24	-	6,81
	58H 200	4	58	234,47	233,09	-	90	58,7	75	24	-	7,26
	60H 200	4	60	242,55	241,18	-	100	58,7	75	24	-	8,25
	70H 200	4	70	282,98	281,61	-	100	58,7	75	28	-	9,20
	72H 200	4	72	291,06	289,69	-	120	58,7	75	28	-	11,09
	84H 200	4	84	339,57	338,20	-	120	58,7	75	28	-	12,63
	96H 200	4	96	388,08	386,71	-	120	58,7	75	28	-	14,51
	120H 200	4	120	485,10	483,73	-	120	58,7	75	28	-	19,15

# H300 | Timing Belt Pulleys



ISO5294-1989

Accept OEM purchase.

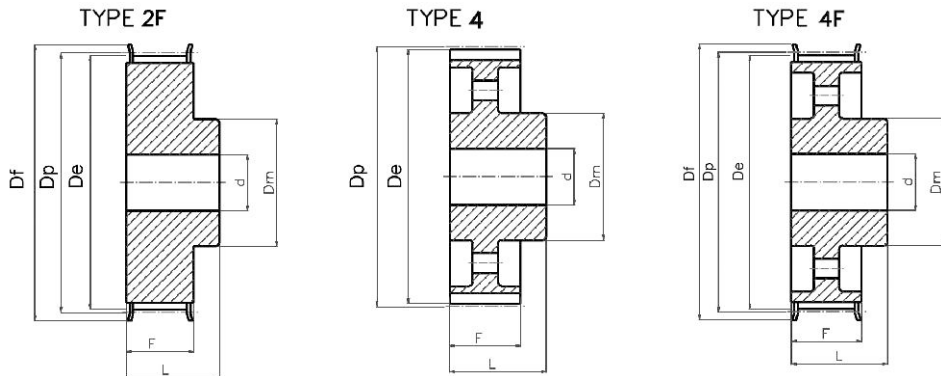

## H300 PITCH 1/2" (12,7mm)

MATERIAL	CODE	TYPE	TEETH	Dp	De	Df	Dm	F	L	d	TYPE OF FLANGE	Kg.
STEEL	14H 200	2F	14	56,59	55,22	63	40	85,7	100	18	309	1,64
	15H 200	2F	15	60,64	59,27	66	45	85,7	100	18	310	1,91
	16H 200	2F	16	64,68	63,31	71	45	85,7	100	18	311	2,16
	17H 200	2F	17	68,72	67,35	75	45	85,7	100	18	312	2,43
	18H 200	2F	18	72,77	71,39	79	55	85,7	100	18	313	2,80
	19H 200	2F	19	76,81	75,44	83	60	85,7	100	18	314	3,16
	20H 200	2F	20	80,85	79,48	87	62	85,7	100	18	315	3,50
	21H 200	2F	21	84,89	83,52	91	65	85,7	100	18	316	3,87
	22H 200	2F	22	88,94	87,56	93	68	85,7	100	18	317	4,26
	23H 200	2F	23	92,98	91,61	97	72	85,7	100	18	318	4,68
	24H 200	2F	24	97,03	95,65	103	72	85,7	100	18	320	5,08
	25H 200	2F	25	101,06	99,69	106	72	85,7	100	18	321	5,45
	26H 200	2F	26	105,11	103,73	111	80	85,7	100	18	322	6,01
	27H 200	2F	27	109,15	107,78	115	80	85,7	100	18	323	6,45
	28H 200	2F	28	113,19	111,82	119	80	85,7	100	18	325	6,91
	30H 200	2F	30	121,29	119,90	127	80	85,7	100	18	327	7,90
	32H 200	2F	32	129,36	127,99	135	80	85,7	100	18	328	8,92
	33H 200	2F	33	133,40	132,03	140	80	85,7	100	18	330	9,46
	34H 200	2F	34	137,45	136,07	143	80	85,7	100	18	331	10,04
	35H 200	2F	35	141,49	140,12	148	80	85,7	100	18	333	10,62
36H 200	2F	36	145,53	144,16	152	80	85,7	100	18	334	11,24	
38H 200	2F	38	153,62	152,24	158	80	85,7	100	18	335	12,44	
40H 200	2F	40	161,70	160,33	168	80	85,7	100	18	338	13,80	
CAST IRON	44H 200	4F	44	177,87	176,50	184	80	85,7	100	24	339	7,22
	48H 200	4F	48	194,04	192,67	200	90	85,7	100	24	342	8,60
	50H 200	4	50	202,13	200,75	-	90	85,7	100	24	-	8,99
	58H 200	4	58	234,47	233,09	-	90	85,7	100	24	-	10,04
	60H 200	4	60	242,55	241,18	-	100	85,7	100	24	-	11,18
	72H 200	4	72	291,06	289,69	-	120	85,7	100	28	-	15,07
	84H 200	4	84	339,57	338,20	-	120	85,7	100	28	-	16,97
	96H 200	4	96	388,08	386,71	-	120	85,7	100	28	-	19,86
	120H 200	4	120	485,10	483,73	-	120	85,7	100	28	-	25,91

ISO5294-1989



Accept OEM purchase.

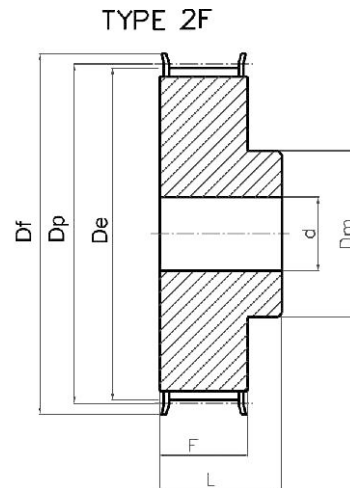

## XH200 PITCH 7/8" (22,22mm)

MATERIAL	CODE	TYPE	TEETH	Dp	De	Df	Dm	F	L	d	TYPE OF FLANGE	Kg.
STEEL	18XH 200	2F	18	127,34	124,55	138	100	65	80	24	401	6,00
	19XH 200	2F	19	134,41	131,62	146	100	65	80	24	402	6,60
	20XH 200	2F	20	141,49	138,69	154	100	65	80	24	403	7,30
	21XH 200	2F	21	148,56	145,77	160	110	65	80	24	404	8,73
	22XH 200	2F	22	155,64	152,84	168	110	65	80	24	405	9,55
	24XH 200	2F	24	169,79	166,99	183	120	65	80	24	406	11,47
	25XH 200	2F	25	176,86	174,07	188	120	65	80	24	407	12,46
	26XH 200	2F	26	183,93	181,14	198	120	65	80	24	409	13,47
	27XH 200	2F	27	191,01	188,22	200	120	65	80	24	410	14,42
	28XH 200	2F	28	198,09	195,29	211	120	65	80	24	411	15,44
	30XH 200	2F	30	212,23	209,44	226	120	65	80	24	412	17,69
	32XH 200	2F	32	226,38	223,59	240	120	65	80	24	414	19,95
	34XH 200	2F	34	240,53	237,74	256	120	65	80	24	415	22,75

ISO5294-1989

TYPE 2F

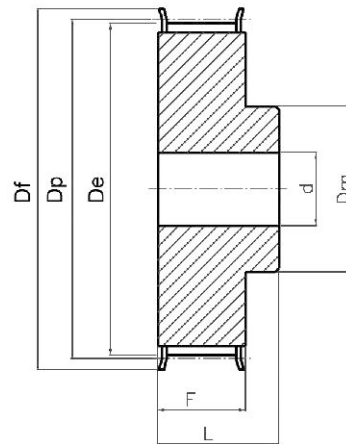

Accept OEM purchase.

## XH300 PITCH 7/8" (22,22mm)

MATERIAL	CODE	TYPE	TEETH	Dp	De	Df	Dm	F	L	d	TYPE OF FLANGE	Kg.
STEEL	18XH 300	2F	18	127,34	124,55	138	100	92	110	28	401	8,90
	19XH 300	2F	19	134,41	131,62	146	100	92	110	28	402	9,20
	20XH 300	2F	20	141,49	138,69	154	100	92	110	28	403	10,61
	21XH 300	2F	21	148,56	145,77	160	110	92	110	28	404	11,87
	22XH 300	2F	22	155,64	152,84	168	110	92	110	28	405	13,08
	24XH 300	2F	24	169,79	166,99	183	120	92	110	28	406	15,77
	25XH 300	2F	25	176,86	174,07	188	120	92	110	28	407	17,13
	26XH 300	2F	26	183,93	181,14	198	120	92	110	28	409	18,55
	27XH 300	2F	27	191,01	188,22	200	120	92	110	28	410	19,90
	28XH 300	2F	28	198,09	195,29	211	150	92	110	28	411	22,27
	30XH 300	2F	30	212,23	209,44	226	150	92	110	28	412	25,39
	32XH 300	2F	32	226,38	223,59	240	150	92	110	28	414	28,73
	34XH 300	2F	34	240,53	237,74	256	150	92	110	28	415	34,20

ISO5294-1989

Accept OEM purchase.

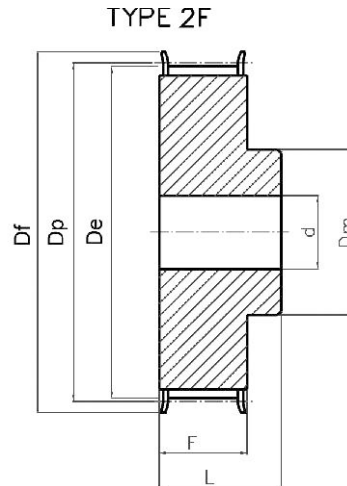

## XH 400 PITCH 7/8" (22,22mm)

MATERIAL	CODE	TYPE	TEETH	Dp	De	Df	Dm	F	L	d	TYPE OF FLANGE	Kg.
STEEL	18XH 400	2F	18	127,34	124,55	138	100	119	132	32	401	9,60
	19XH 400	2F	19	134,41	131,62	146	100	119	132	32	402	10,80
	20XH 400	2F	20	141,49	138,69	154	100	119	132	32	403	12,87
	21XH 400	2F	21	148,56	145,77	160	110	119	132	32	404	14,42
	22XH 400	2F	22	155,64	152,84	168	110	119	132	32	405	15,44
	24XH 400	2F	24	169,79	166,99	183	120	119	132	32	406	19,22
	25XH 400	2F	25	176,86	174,07	188	120	119	132	32	407	21,05
	26XH 400	2F	26	183,93	181,14	198	120	119	132	32	409	22,80
	27XH 400	2F	27	191,01	188,22	200	120	119	132	32	410	24,66
	28XH 400	2F	28	198,09	195,29	211	150	119	132	32	411	27,23
	30XH 400	2F	30	212,23	209,44	226	150	119	132	32	412	31,30
	32XH 400	2F	32	226,38	223,59	240	150	119	132	32	414	35,20
	34XH 400	2F	34	240,53	237,74	256	150	119	132	32	415	40,00

### Special Note

The material of pulley can be S45C, GG25, FFF40, aluminum, nylon and stainless steel etc. The surface finish can be black oxide, phosphating, anodization and zinc plated.



# L050 | Timing Belt Pulleys for Taper Bushes



**Taper Bore**

All series of the timing pulleys XL-XXH, 3M-20M, T2.5-T20 and AT5-AT10. Produced by Part are adopted advanced production technology and so have high quality. They are really the first choice of users



## L 050 PITCH 3/8" (9,525mm)

MATERIAL	CODE	TYPE	TEETH	BUSH	MAX BORE	Dp	De	Df	Dm	Di	F	L	R	TYPE OF FLANGE	Kg.
STEEL	TL 18L 050	10F	18	1108	28	54,57	53,81	60	44	-	19,0	22,0	3	308	0,20
	TL 19L 050	10F	19	1108	28	57,61	56,84	63	44	-	19,0	22,0	3	309	0,23
	TL 20L 050	10F	20	1108	28	60,64	59,88	66	48	-	19,0	22,0	3	310	0,27
	TL 21L 050	10F	21	1108	28	63,67	62,91	71	48	-	19,0	22,0	3	311	0,30
	TL 22L 050	10F	22	1108	28	66,70	65,94	75	51	-	19,0	22,0	3	312	0,34
	TL 23L 050	10F	23	1108	28	69,73	68,97	79	54	-	19,0	22,0	3	313	0,40
	TL 24L 050	10F	24	1108	28	72,77	72,00	79	54	-	19,0	22,0	3	313	0,45
	TL 25L 050	10F	25	1108	28	75,80	75,04	83	56	-	19,0	22,0	3	314	0,50
	TL 26L 050	10F	26	1108	28	78,83	78,07	87	60	-	19,0	22,0	3	315	0,55
	TL 27L 050	10F	27	1108	28	81,86	81,10	87	62	-	19,0	22,0	3	315	0,60
	TL 28L 050	10F	28	1108	28	84,89	84,13	91	65	-	19,0	22,0	3	316	0,65
	TL 30L 050	10F	30	1108	28	90,96	90,20	97	70	-	19,0	22,0	3	318	0,80
	TL 32L 050	10F	32	1108	28	97,02	96,26	103	74	-	19,0	22,0	3	320	0,98
	TL 36L 050	10F	36	1108	28	109,15	108,39	115	85	-	19,0	22,0	3	323	1,20
	TL 40L 050	10F	40	1610	42	121,28	120,51	127	97	-	19,0	25,0	6	327	1,40
	TL 48L 050	11F	48	1610	42	145,53	144,77	152	88	120	19,0	25,0	6	334	2,30
	TL 60L 050	13	60	1610	42	181,91	181,15	-	92	166	19,0	25,0	3	-	2,20
	CAST IRON	TL 72L 050	14	72	1610	42	218,30	217,53	-	92	202	19,0	25,0	3	-
TL 84L 050		14	84	1610	42	254,68	253,90	-	92	236	19,0	25,0	3	-	2,46
TL 96L 050		14	96	2012	50	291,06	290,30	-	106	270	19,0	32,0	6,5	-	2,36
TL 120L 050		14	120	2012	50	363,83	363,07	-	106	343	19,0	32,0	6,5	-	4,44

Timing Belt Pulleys

# L075/L100 | Timing Belt Pulleys for Taper Bushes



**Taper Bore**

## L 075 PITCH 3/8" (9,525mm)

MATERIAL	CODE	TYPE	TEETH	BUSH	MAX BORE	Dp	De	Df	Dm	Di	F	L	R	TYPE OF FLANGE	Kg
STEEL	TL 18L 075	15F	18	1108	28	54,57	53,81	60	-	-	25,0	25,0	-	308	0,25
	TL 19L 075	15F	19	1108	28	57,61	56,84	63	-	-	25,0	25,0	-	309	0,32
	TL 20L 075	15F	20	1108	28	60,64	59,88	66	-	-	25,0	25,0	-	310	0,35
	TL 21L 075	15F	21	1108	28	63,67	62,91	71	-	-	25,0	25,0	-	311	0,40
	TL 22L 075	15F	22	1108	28	66,70	65,94	75	-	-	25,0	25,0	-	312	0,44
	TL 23L 075	15F	23	1108	28	69,73	68,97	79	-	-	25,0	25,0	-	313	0,48
	TL 24L 075	15F	24	1108	28	72,77	72,00	79	-	-	25,0	25,0	-	313	0,55
	TL 25L 075	15F	25	1108	28	75,80	75,04	83	-	-	25,0	25,0	-	314	0,63
	TL 26L 075	15F	26	1108	28	78,83	78,07	87	-	-	25,0	25,0	-	315	0,66
	TL 27L 075	15F	27	1108	28	81,86	81,10	87	-	-	25,0	25,0	-	315	0,70
	TL 28L 075	15F	28	1108	28	84,89	84,13	91	-	-	25,0	25,0	-	316	0,72
	TL 30L 075	15F	30	1108	28	90,96	90,20	97	-	-	25,0	25,0	-	318	0,93
	TL 32L 075	15F	32	1108	28	97,02	96,26	103	-	-	25,0	25,0	-	320	1,10
	TL 36L 075	15F	36	1610	42	109,15	108,39	115	-	-	25,0	25,0	-	323	1,20
	TL 40L 075	15F	40	1610	42	121,28	120,51	127	-	-	25,0	25,0	-	327	1,70
	TL 48L 075	21F	48	1610	42	145,53	144,77	152	92	120	25,0	25,0	-	334	2,60
TL 60L 075	21	60	1610	42	181,91	181,15	-	92	166	25,0	25,0	-	-	3,00	
CAST IRON	TL 72L 075	22	72	1610	42	218,30	217,53	-	92	202	25,0	25,0	-	-	2,33
	TL 84L 075	14	84	2012	50	254,68	253,90	-	106	236	25,0	32,0	3,5	-	3,55
	TL 96L 075	14	96	2012	50	291,06	290,30	-	106	270	25,0	32,0	3,5	-	3,95
	TL120L075	14	120	2012	50	363,83	363,07	-	106	343	25,0	32,0	3,5	-	5,61

## L 100 PITCH 3/8"

MATERIAL	CODE	TYPE	TEETH	BUSH	MAX BORE	Dp	De	Df	Dm	Di	F	L	R	TYPE OF FLANGE	Kg.
STEEL	TL 18L 100	16F	18	1108	28	54,57	53,81	60	-	38	31,0	22,0	9,0	308	0,20
	TL 19L 100	16F	19	1108	28	57,61	56,84	63	-	38	31,0	22,0	9,0	309	0,32
	TL 20L 100	16F	20	1108	28	60,64	59,88	66	-	45	31,0	22,0	9,0	310	0,41
	TL 21L 100	16F	21	1108	28	63,67	62,91	71	-	45	31,0	22,0	9,0	311	0,45
	TL 22L 100	16F	22	1108	28	66,70	65,94	75	-	48	31,0	22,0	9,0	312	0,47
	TL 23L 100	16F	23	1108	28	69,73	68,97	79	-	52	32,0	22,0	10,0	313	0,50
	TL 24L 100	16F	24	1108	28	72,77	72,00	79	-	52	32,0	22,0	10,0	313	0,64
	TL 25L 100	16F	25	1108	28	75,80	75,04	83	-	54	32,0	22,0	10,0	314	0,68
	TL 26L 100	16F	26	1108	28	78,83	78,07	87	-	60	32,0	22,0	10,0	315	0,70
	TL 27L 100	16F	27	1108	28	81,86	81,10	87	-	60	32,0	22,0	10,0	315	0,83
	TL 28L 100	16F	28	1108	28	84,89	84,13	91	-	65	32,0	22,0	10,0	316	0,85
	TL 30L 100	16F	30	1210	32	90,96	90,20	97	-	71	32,0	25,0	7,0	318	0,90
	TL 32L 100	16F	32	1210	32	97,02	96,26	103	-	75	32,0	25,0	7,0	320	1,05
	TL 36L 100	16F	36	1610	42	109,15	108,39	115	-	86	32,0	25,0	7,0	323	1,40
	TL 40L 100	16F	40	1610	42	121,28	120,51	127	-	96	32,0	25,0	7,0	327	1,65
	TL 48L 100	17F	48	1610	42	145,53	144,77	152	92	120	32,0	25,0	7,0	334	2,80
TL 60L 100	19	60	1610	42	181,91	181,15	-	92	166	32,0	25,0	3,5	-	2,70	
CAST IRON	TL 72L 100	22	72	1610	42	218,30	217,53	-	106	202	32,0	32,0	-	-	2,96
	TL 84L 100	22	84	2012	50	254,68	253,90	-	106	236	32,0	32,0	-	-	3,87
	TL 96L 100	22	96	2012	50	291,06	290,30	-	106	270	32,0	32,0	-	-	4,64
	TL120L100	22	120	2012	50	363,83	363,07	-	106	343	32,0	32,0	-	-	6,37

# H100/H150 | Timing Belt Pulleys for Taper Bushes



**Taper Bore**

## H 100 PITCH 1/2" (12,7mm)

MATERIAL	CODE	TYPE	TEETH	BUSH	MAX BORE	Dp	De	Df	Dm	Di	F	L	R	TYPE OF FLANGE	Kg
STEEL	TL 16H 100	16F	16	1108	28	64,68	63,31	71	-	45	31,0	22,0	9,0	311	0.42
	TL 18H 100	16F	18	1210	32	72,77	71,39	79	-	52	31,0	25,0	6,0	313	0.49
	TL 19H 100	16F	19	1210	32	76,81	75,44	83	-	56	31,0	25,0	6,0	314	0.62
	TL 20H 100	16F	20	1210	32	80,85	79,48	87	-	60	31,0	25,0	6,0	315	0.73
	TL 21H 100	16F	21	1210	32	84,89	83,52	91	-	64	32,0	25,0	7,0	316	0.80
	TL 22H 100	16F	22	1210	32	88,94	87,56	93	-	67	32,0	25,0	7,0	317	0.94
	TL 23H 100	16F	23	1610	42	92,98	91,61	97	-	70	32,0	25,0	7,0	318	0.97
	TL 24H 100	16F	24	1610	42	97,02	95,65	103	-	73,5	32,0	25,0	7,0	320	1.05
	TL 25H 100	16F	25	1610	42	101,06	99,69	106	-	77	32,0	25,0	7,0	321	1.10
	TL 26H 100	16F	26	1610	42	105,11	103,73	111	-	82	32,0	25,0	7,0	322	1.20
	TL 27H 100	16F	27	1610	42	109,15	107,78	115	-	85	32,0	25,0	7,0	323	1.35
	TL 28H 100	16F	28	1610	42	113,19	111,82	119	-	90,5	32,0	25,0	7,0	325	1.50
	TL 30H 100	16F	30	1610	42	121,28	119,90	127	-	98	32,0	25,0	7,0	327	1.78
	TL 32H 100	17F	32	1610	42	129,36	127,99	135	90	106	32,0	25,0	7,0	328	2.05
	TL 36H 100	17F	36	1610	42	145,53	144,16	152	92	121	32,0	25,0	7,0	334	2.80
	TL 40H 100	17F	40	1610	42	161,70	160,33	168	92	138	32,0	25,0	7,0	338	3.65
	TL 44H 100	21F	44	2012	50	177,87	176,50	184	106	152	32,0	32,0	-	339	3.86
	TL 48H 100	21F	48	2012	50	194,04	192,67	200	106	169	32,0	32,0	-	342	4.20
CAST IRON	TL 60H 100	20	60	2012	50	242,55	241,18	-	106	223	34,0	32,0	1,0	-	3.76
	TL 72H 100	20	72	2012	50	291,06	289,69	-	106	270	34,0	32,0	1,0	-	4.88
	TL 84H 100	20	84	2012	50	339,57	338,20	-	106	320	34,0	32,0	1,0	-	6.12
	TL 96H 100	14	96	2517	60	388,08	386,71	-	119	366	34,0	45,0	5,5	-	7.95
	TL 120H 100	14	120	2517	60	485,10	483,73	-	119	462	34,0	45,0	5,5	-	10.05

## H 150 PITCH 1/2"

MATERIAL	CODE	TYPE	TEETH	BUSH	MAX BORE	Dp	De	Df	Dm	Di	F	L	R	TYPE OF FLANGE	Kg
STEEL	TL 18H 150	16F	18	1210	32	72,77	71,39	79	-	52	45,0	25,0	20,0	313	0.60
	TL 19H 150	16F	19	1210	32	76,81	75,44	83	-	56	45,0	25,0	20,0	314	0.72
	TL 20H 150	16F	20	1210	32	80,85	79,48	87	-	60	45,0	25,0	20,0	315	0.83
	TL 21H 150	16F	21	1210	32	84,89	83,52	91	-	64	45,0	25,0	20,0	316	1.00
	TL 22H 150	16F	22	1210	32	88,94	87,56	93	-	67	45,0	25,0	20,0	317	1.25
	TL 23H 150	16F	23	1610	42	92,98	91,61	97	-	70	45,0	25,0	20,0	318	1.05
	TL 24H 150	16F	24	1610	42	97,02	95,65	103	-	73,5	45,0	25,0	20,0	320	1.10
	TL 25H 150	16F	25	1610	42	101,06	99,69	106	-	77	45,0	25,0	20,0	321	1.30
	TL 26H 150	16F	26	1610	42	105,11	103,73	111	-	82	45,0	25,0	20,0	322	1.42
	TL 27H 150	16F	27	1610	42	109,15	107,78	115	-	85	45,0	25,0	20,0	323	1.65
	TL 28H 150	16F	28	1610	42	113,19	111,82	119	-	90,5	45,0	25,0	20,0	325	1.88
	TL 30H 150	16F	30	1610	42	121,28	119,90	127	-	98	45,0	25,0	20,0	327	2.05
	TL 32H 150	17F	32	1610	42	129,36	127,99	135	90	106	45,0	25,0	20,0	328	2.35
	TL 36H 150	17F	36	1610	42	145,53	144,16	152	92	121	45,0	25,0	20,0	334	3.20
	TL 40H 150	17F	40	1610	42	161,70	160,33	168	92	138	45,0	25,0	20,0	338	4.10
	TL 44H 150	17F	44	2012	50	177,87	176,50	184	106	152	45,0	32,0	13,0	339	4.50
	TL 48H 150	17F	48	2012	50	194,04	192,67	200	106	169	45,0	32,0	13,0	342	4.80
	CAST IRON	TL 60H 150	20	60	2012	50	242,55	241,18	-	106	223	46,0	32,0	7,0	-
TL 72H 150		20	72	2012	50	291,06	289,69	-	106	270	46,0	32,0	7,0	-	6.16
TL 84H 150		20	84	2012	50	339,57	338,20	-	106	320	46,0	32,0	7,0	-	7.40
TL 96H 150		20	96	2517	60	388,08	386,71	-	119	366	46,0	45,0	0,5	-	9.87
TL 120H 150		20	120	2517	60	485,10	483,73	-	119	462	46,0	45,0	0,5	-	13.50

Timing Belt Pulleys



GOODWILL

# H200/H300 | Timing Belt Pulleys for Taper Bushes

**Taper Bore**

## H 200 PITCH 1/2" (12,7mm)

MATERIAL	CODE	TYPE	TEETH	BUSH	MAX BORE	Dp	De	Df	Dm	Di	F	L	R	TYPE OF FLANGE	Kg
STEEL	TL18H 200	16F	18	1210	32	72,77	71,39	79	-	52	58,0	25,0	33,0	313	0.84
	TL19H 200	16F	19	1210	32	76,81	75,44	83	-	56	58,0	25,0	33,0	314	0.96
	TL20H 200	16F	20	1610	42	80,85	79,48	87	-	60	58,0	25,0	33,0	315	0.93
	TL21H 200	16F	21	1610	42	84,89	83,52	91	-	64	58,0	25,0	33,0	316	1.07
	TL22H 200	16F	22	1610	42	88,94	87,56	93	-	67	58,0	25,0	33,0	317	1.25
	TL23H 200	16F	23	1610	42	92,98	91,61	97	-	70	58,0	25,0	33,0	318	1.40
	TL24H 200	16F	24	1610	42	97,02	95,65	103	-	73,5	58,0	25,0	33,0	320	1.55
	TL25H 200	16F	25	1610	42	101,06	99,69	106	-	77	58,0	25,0	33,0	321	1.71
	TL26H 200	16F	26	1610	42	105,11	103,73	111	-	82	58,0	25,0	33,0	322	1.84
	TL27H 200	16F	27	1610	42	109,15	107,78	115	-	85	58,0	25,0	33,0	323	2.06
	TL28H 200	16F	28	1610	42	113,19	111,82	119	-	90,5	58,0	25,0	33,0	325	2.17
	TL30H 200	16F	30	1610	42	121,28	119,90	127	-	98	58,0	25,0	33,0	327	2.60
	TL32H 200	16F	32	2012	50	129,36	127,99	135	-	106	58,0	32,0	26,0	328	2.95
	TL36H 200	17F	36	2012	50	145,53	144,16	152	102	121	58,0	32,0	26,0	334	3.62
	TL40H 200	17F	40	2012	50	161,70	160,33	168	106	138	58,0	32,0	26,0	338	4.33
	TL44H 200	17F	44	2012	50	177,87	176,50	184	106	152	58,0	32,0	26,0	339	5.33
TL48H 200	17F	48	2517	60	194,04	192,67	200	119	169	58,0	45,0	13,0	342	6.47	
CAST IRON	TL60H 200	20	60	2517	60	242,55	241,18	-	119	223	60,0	45,0	7,5	-	5.86
	TL72H 200	20	72	2517	60	291,06	289,69	-	119	270	60,0	45,0	7,5	-	7.42
	TL84H 200	20	84	2517	60	339,57	338,20	-	119	320	60,0	45,0	7,5	-	8.73
	TL96H 200	20	96	2517	60	388,08	386,71	-	119	366	60,0	45,0	7,5	-	10.83
	TL120H200	20	120	2517	60	485,10	483,73	-	119	462	60,0	45,0	7,5	-	14.95

## H 300 PITCH 1/2"

MATERIAL	CODE	TYPE	TEETH	BUSH	MAX BORE	Dp	De	Df	Dm	Di	F	L	R	TYPE OF FLANGE	Kg
STEEL	TL20H 300	18F	20	1615	42	80,85	79,48	87	-	64,5	84,0	38,0	23,0	315	1.22
	TL21H 300	18F	21	1615	42	84,89	83,52	91	-	65	84,0	38,0	23,0	316	1.52
	TL22H 300	18F	22	1615	42	88,94	87,56	93	-	67	84,0	38,0	23,0	317	1.80
	TL23H 300	18F	23	1615	42	92,98	91,61	97	-	70	84,0	38,0	23,0	318	2.04
	TL24H 300	18F	24	1615	42	97,02	95,65	103	-	73,5	84,0	38,0	23,0	320	2.29
	TL25H 300	18F	25	1615	42	101,06	99,69	106	-	77	84,0	38,0	23,0	321	2.54
	TL26H 300	18F	26	1615	42	105,11	103,73	111	-	82	84,0	38,0	23,0	322	2.73
	TL27H 300	18F	27	2012	50	109,15	107,78	115	-	85	84,0	32,0	26,0	323	2.54
	TL28H 300	18F	28	2012	50	113,19	111,82	119	-	90,5	84,0	32,0	26,0	325	2.68
	TL30H 300	18F	30	2012	50	121,28	119,90	127	-	98	84,0	32,0	26,0	327	3.21
	TL32H 300	18F	32	2517	60	129,36	127,99	135	-	106	84,0	45,0	19,5	328	3.58
	TL36H 300	18F	36	2517	60	145,53	144,16	152	-	121	84,0	45,0	19,5	334	4.99
	TL40H 300	18F	40	2517	60	161,70	160,33	168	-	138	84,0	45,0	19,5	338	6.50
	TL44H 300	19F	44	2517	60	177,87	176,50	184	119	152	86,0	45,0	20,5	339	7.55
	TL48H 300	19F	48	2517	60	194,04	192,67	200	119	169	86,0	45,0	20,5	342	8.66
	CAST IRON	TL60H 300	20	60	2517	60	242,55	241,18	-	119	223	86,0	45,0	20,5	-
TL72H 300		20	72	2517	60	291,06	289,69	-	119	270	86,0	45,0	20,5	-	9.33
TL84H 300		20	84	2517	60	339,57	338,20	-	119	320	86,0	45,0	20,5	-	11.19
TL96H 300		20	96	3030	75	388,08	386,71	-	150	362	86,0	76,0	5,0	-	17.96
TL120H300		20	120	3030	75	485,10	483,73	-	150	460	86,0	76,0	5,0	-	22.23

## Timing Pulley

We can also supply the flanges of the above timing belt pulleys separately. The customers can order flanges according to the corresponding pulleys part numbers.

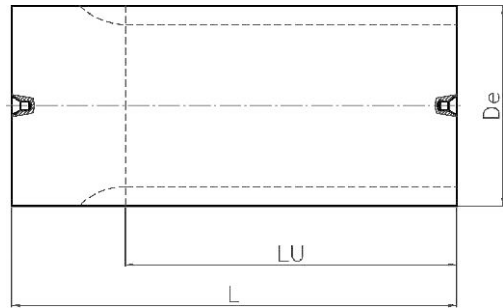

### XL PITCH 1/5" (5,08mm)

CODE	TEETH	DE	LU	L
XL 10	10	15,66	140	140
XL 11	11	17,28	140	140
XL 12	12	18,90	140	140
XL 13	13	20,51	140	140
XL 14	14	22,13	140	140
XL 15	15	23,75	140	140
XL 16	16	25,36	140	140
XL 17	17	26,98	140	140
XL 18	18	28,60	140	140
XL 19	19	30,22	140	140
XL 20	20	31,83	140	140
XL 21	21	33,45	160	160
XL 22	22	35,07	160	160
XL 23	23	36,60	160	160
XL 24	24	38,30	160	160
XL 25	25	39,92	160	160
XL 26	26	41,53	160	160
XL 27	27	43,15	160	160
XL 28	28	44,77	160	160
XL 29	29	46,39	160	160
XL 30	30	48,00	160	160
XL 32	32	51,24	160	160
XL 33	33	52,85	160	160
XL 34	34	54,47	160	160
XL 35	35	56,09	160	160
XL 36	36	57,70	160	160
XL 38	38	60,94	160	160
XL 39	39	62,56	160	160
XL 40	40	64,17	160	160
XL 41	41	65,79	160	160
XL 42	42	67,41	160	160
XL 43	43	69,02	160	160
XL 44	44	70,64	160	160
XL 48	48	77,11	160	160
XL 56	56	90,04	160	160
XL 60	60	96,51	160	160
XL 72	72	115,92	160	160

### L PITCH 3/8" (9,525mm)

CODE	TEETH	DE	LU	L
L 10	10	29,56	140	140
L 11	11	32,59	140	140
L 12	12	35,62	160	160
L 13	13	38,65	160	160
L 14	14	41,68	160	160
L 15	15	44,72	160	160
L 16	16	47,75	160	160
L 17	17	50,78	160	160
L 18	18	53,81	160	160
L 19	19	56,84	160	160
L 20	20	59,88	160	160
L 21	21	62,91	160	160
L 22	22	65,94	160	160
L 23	23	68,97	160	160
L 24	24	72,00	160	160
L 27	27	81,10	160	160
L 30	30	90,20	160	160